



**LIBERO CE**

- > Multi-Use PDF Logger
- > External Pt100 probe
- > No software for data download



TECHNICAL SPECIFICATIONS

# LIBERO CE

Multi-Level and Multi-Use PDF Logger with USB interface for external Pt100 Probe

LIBERO CE is the ideal PDF Logger to simplify storage and shipment process for products with known stability data. It covers a wide measurement range from -200 °C to +400 °C and monitors temperature of cell and drug deliveries with cryogenic containers, dry ice or other applications using an external Pt100 probe. Supporting up to eight temperature alarm zones, MKT and duration as alarm criteria – LIBERO CE allows you to create temperature profiles for individual products. In addition, you have the option to switch the alarming function off and on again if alarming criteria is required. This can be useful in cases where a transportation box has been cleaned, or liquid nitrogen has been refilled in a cryogenic container. LIBERO CE is reconfigurable and reusable for up to 3 years. The external Pt100 probe and M8 connector enables reliable, superior temperature data transfer to the data logger. Up to 75'500 temperature values can be stored on the data logger. LIBERO CE can be ordered with an optional stainless steel bracket. Release products with confidence based on the OK or ALARM status on the display and download the PDF report via the convenient USB interface without any additional software being required.

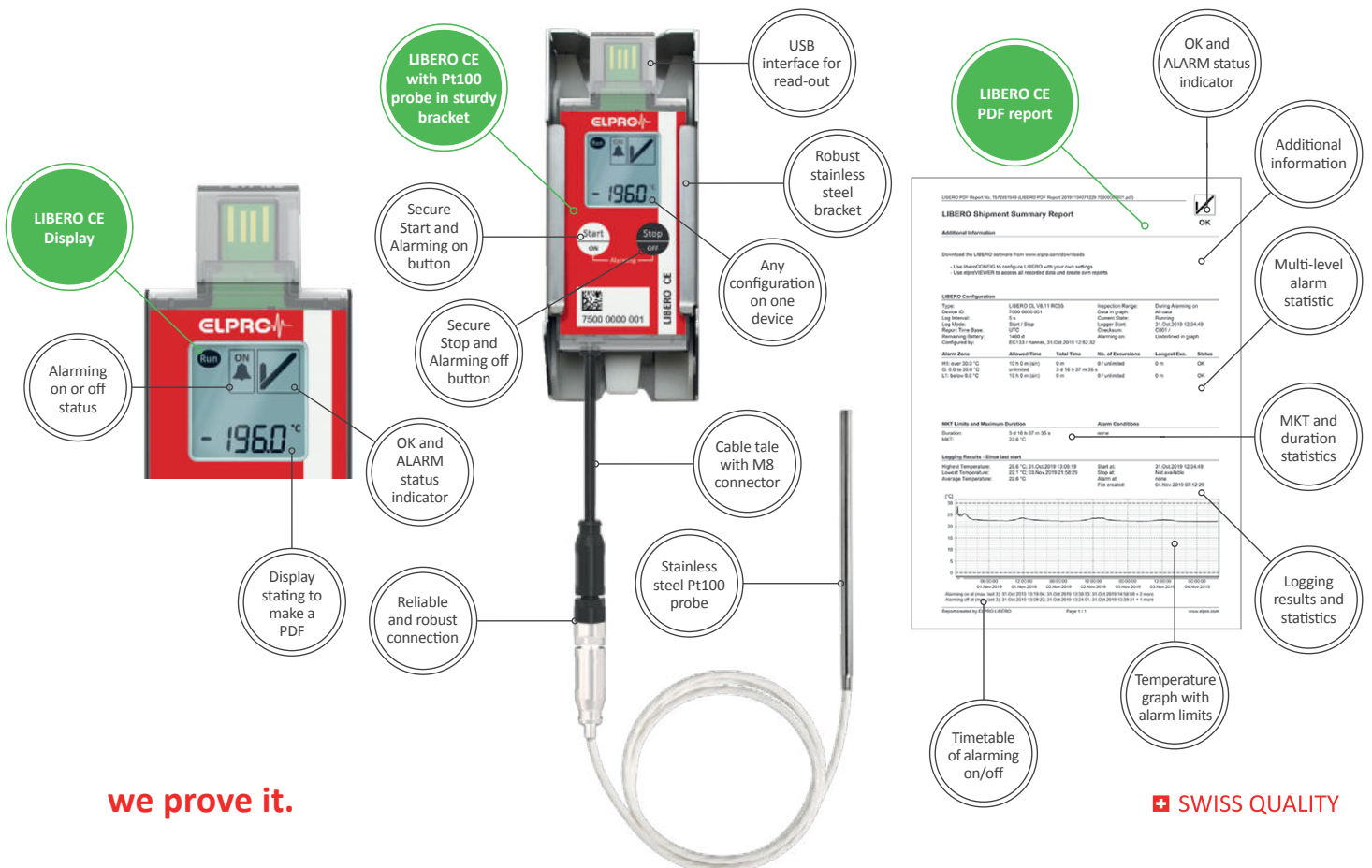

**we prove it.**

**SWISS QUALITY**



- > Monitors valuable goods in ultra-low freezers and during cryogenic shipments
- > Simple and safe in use
- > Compatible with ELPRO's liberoMANAGER cold chain database
- > Alarming on and alarming off

## Technical Specifications LIBERO CE

<b>Type</b>	PDF Logger with USB interface for external Pt100 temperature probe (probe not included)								
<b>Application area</b>	Site Monitoring, Container Monitoring, Cryo Container Monitoring, Dry-ice Container Monitoring								
<b>Recording options and mode</b>	Multiple use: start/stop or loop mode								
<b>Type of probe</b>	Pt100 probe (4-wire measuring technique), max. cable length 3 m (118.1 inch), requires M8 connector								
<b>Measurement range</b>	Measurement range (depending on probe): -200 °C..+400 °C Operating range of data logger: -30 °C..+70 °C								
<b>Measurement accuracy</b>	<b>System accuracy*:</b> <table style="width: 100%; border: none;"> <tr> <td style="width: 50%;">±1.4 °C in the range of -200.0 °C..-100.1 °C (Class B)</td> <td style="width: 50%;">±0.5 °C in the range of +25.1 °C..+100.0 °C (Class A)</td> </tr> <tr> <td>±1.0 °C in the range of -100.0 °C..-50.1 °C (Class B)</td> <td>±0.7 °C in the range of +100.1 °C..+200.0 °C (Class A)</td> </tr> <tr> <td>±0.4 °C in the range of -50.0 °C..-10.1 °C (Class A)</td> <td>±1.1 °C in the range of +200.1 °C..+400.0 °C (Class A)</td> </tr> <tr> <td>±0.3 °C in the range of -10.0 °C..+25.0 °C (Class A)</td> <td></td> </tr> </table> *Includes data logger and external Pt100 probe of stated class	±1.4 °C in the range of -200.0 °C..-100.1 °C (Class B)	±0.5 °C in the range of +25.1 °C..+100.0 °C (Class A)	±1.0 °C in the range of -100.0 °C..-50.1 °C (Class B)	±0.7 °C in the range of +100.1 °C..+200.0 °C (Class A)	±0.4 °C in the range of -50.0 °C..-10.1 °C (Class A)	±1.1 °C in the range of +200.1 °C..+400.0 °C (Class A)	±0.3 °C in the range of -10.0 °C..+25.0 °C (Class A)	
±1.4 °C in the range of -200.0 °C..-100.1 °C (Class B)	±0.5 °C in the range of +25.1 °C..+100.0 °C (Class A)								
±1.0 °C in the range of -100.0 °C..-50.1 °C (Class B)	±0.7 °C in the range of +100.1 °C..+200.0 °C (Class A)								
±0.4 °C in the range of -50.0 °C..-10.1 °C (Class A)	±1.1 °C in the range of +200.1 °C..+400.0 °C (Class A)								
±0.3 °C in the range of -10.0 °C..+25.0 °C (Class A)									
<b>Measurement resolution</b>	0.1 °C								
<b>Measurement interval</b>	1 to 60 minutes, user configurable								
<b>Memory capacity</b>	75'500 measurement values (equals logging duration of 17 months at 10 minute logging interval)								
<b>Battery life</b>	3 years								
<b>Battery type</b>	Button cell contained in equipment UN3091, exempt from DGR declaration Non-replaceable battery								
<b>Configurable alarms</b>	8 temperature alarm zones with single or cumulative delays, Alarm on MKT, Alarm on duration/run time								
<b>Start-up delay</b>	User configurable based on time or temperature								
<b>Display</b>	Multifunction LCD, size: 22 × 22 mm (0.87 x 0.87 inch), with OK and Alarm indicator								
<b>Certificate</b>	Certificate available via <a href="http://compliance.elpro.com">compliance.elpro.com</a> Optional: Additional customer-specific calibration points according to ISO 17025 standard								
<b>Traceability</b>	Unique ID number (traceable to component level)								
<b>Report</b>	Built-in PDF file generator automatically establishes an evaluation report with embedded data upon connection to a USB port. Complies with the ISO standard 19005-1 Document Management for the long-term preservation of electronic documents (PDF/A) and FDA 21 CFR Part 11. - Customizable report title and filename - Text area for additional information (e.g. shipment information, instructions for recipient, etc.) - Statistics (min/max, average, alarm, alarming on/off) and detailed logger information (ID, configuration, etc.) - Chart visualizing the temperature curve and alarm limits								
<b>Case   dimension   weight   IP Code</b>	ABS plastic material   95 × 41 × 11 mm (3.74 x 1.61 x 0.43 inch), cable tail 85 mm (3.35 inch) including M8 connector   44 g (0.1 lb)   IP54								
<b>Accessories</b>	LIBERO CE stainless steel bracket, variety of Pt100 probes, extension cable with M8 connector								
<b>Conformity</b>	CE   FCC   RoHS   Safe Transport of Chemical Goods   WEEE								
<b>Standards and Guidelines</b>	RTCA DO-160   GAMP5								
<b>Data logger configuration and additional analysis software</b>	liberoCONFIG software to create, store and manage individual settings in a logger profile as well as SmartStart, a liberoCONFIG component allowing a safe and quick application of profiles and additional information to PDF Logger. elproVIEWER software to access and export embedded data of PDF report, for data analysis and comprehensive report features. Both software products can be downloaded at <a href="http://www.elpro.com/downloads">www.elpro.com/downloads</a> . Fully compatible with liberoMANAGER database.								