

## Model GC30 Ultra-Compact Digital Differential Pressure Sensor



GC30



GC30 WITH INSTALLED  
PANEL ADAPTOR

ACTUAL SIZE



LOOK FOR THIS  
AGENCY MARK ON  
OUR PRODUCTS

### APPLICATIONS:

- Filter monitoring
- Clean room pressure differential
- Vacuum/suction pressure sensing & control
- Fan speed control

### FEATURES:

- Ultra-compact design 1.2" x 1.2" (30mm x 30mm)
- Combined three-in-one digital pressure gauge, switch and transducer
- Simple "Push-Button" configurability allows user to adjust switch settings, analog scaling
- Numerous standard ranges available

Featuring a highly reliable variable capacitance sensor using the patented Ashcroft® SiGlas™ sensor. This ultra-thin single crystal diaphragm provides inherent sensor repeatability and stability.

#### SENSOR CROSS SECTION

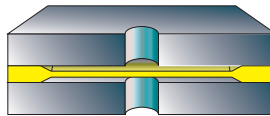

The silicon diaphragm sensor has no glues or other organics to contribute to drift or mechanical degradation over time.

### PRODUCT SPECIFICATIONS

#### Analog Output (1-5Vdc):

Accuracy:  $\pm 1.5\%$  FS (accuracy includes effects of linearity, hysteresis and repeatability)

Response time: 50msec

Output resolution: 25mV

Analog scaling: User may configure analog output scaling to any range within full scale of sensor range

#### Pressure Switch Output:

Type: NPN or PNP open collector up to 30Vdc/80ma

Setting Accuracy:  $\pm 1.5\%$  F.S.

Number of contacts: 2

Time delay: 5 msec –2.0 sec (by user)

Hysteresis: Variable (by user)

Switch setting: User may adjust switch actuation & deadband to any points within full scale sensor range

### Display:

Type: 3½ digit, 10mm LED

Accuracy:  $\pm 1.5\%$  FS + last digit

Display setting: User may re-configure display scaling, set to capture MIN or MAX value, and adjust display update rate.

### Inches of Water Column (" W.C.) Ranges:

#### Standard Ranges (Gauge):

0 to 0.25" W.C., 0.50" W.C., 1.0" W.C., 2.5" W.C., 5.0" W.C., 10" W.C., 25" W.C.

#### Standard Ranges (Compound):

$\pm 0.25$ " W.C.,  $\pm 0.50$ " W.C.,  $\pm 1.0$ " W.C.,  $\pm 2.5$ " W.C.,  $\pm 5.0$ " W.C.,  $\pm 10$ " W.C.,  $\pm 25$ " W.C.

### ENVIRONMENTAL SPECIFICATIONS

#### Temperature Limits:

Storage: -22 to 140°F (-30 to 60°C)

Operating: -4 to 140°F (-20 to 60°C)

Compensated: 14 to 122°F (-10 to 50°C)

#### Temperature Effects:

Zero/Span: (from 73°F/23°C reference temperature)

$\pm 0.09\%/^{\circ}\text{F}$  ( $\pm 0.15\%/^{\circ}\text{C}$ )  $\pm 2.5$ " W.C., 0/2.5" W.C. and below

$\pm 0.06\%/^{\circ}\text{F}$  ( $\pm 0.10\%/^{\circ}\text{C}$ )  $\pm 5.0$ " W.C., 0/5.0" W.C. and above

Humidity: 0-85% RH (Non-Condensing)

### FUNCTIONAL SPECIFICATIONS

Proof pressure: 7.5psid (50kPa)

Burst pressure: 25psig (170kPa)

Max static (line) pressure: 7.5psi (50kPa)

CE Compliance: EN61326-1 2006, EN61326-2-3 2006

### ELECTRICAL SPECIFICATIONS

#### Power Supply Requirements:

Supply voltage: 11-27Vdc

Current consumption: 30mA (max)

#### Switch Contacts:

(2) NPN or PNP open collector outputs

NPN Type: 30Vdc / 80mA (max)

PNP Type: voltage drop 1Vdc (max)/80mA (max)

### MECHANICAL SPECIFICATIONS

Pressure Connection: 4mm barb

Enclosure: ABS, polycarbonate, aluminum

Rating: IP40

Electrical Connection: 6ft (2m) cable pigtail

Weight: Approx. 75 grams

Mounting: Panel mounting bracket included

Media: Clean, dry air/gases compatible with Aluminum, ABS, Ceramic, Silicon, and Silicone RTV

## Model GC30 Ultra-Compact Digital Differential Pressure Sensor

### Dimensions (mm) Inches

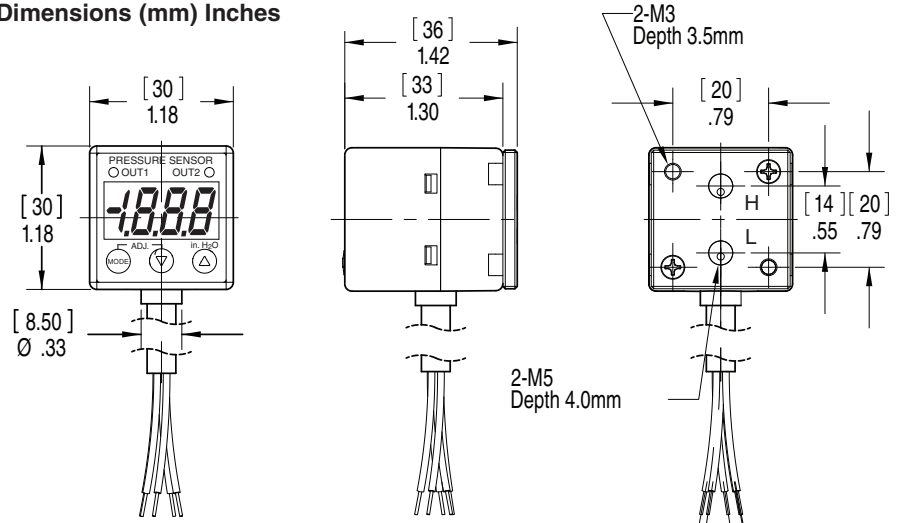

### Panel Mounting Kit (included)

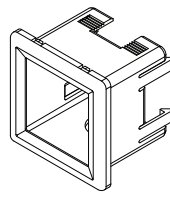

Panel adapter 1 (X1)

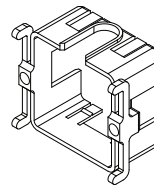

Panel adapter 2 (X1)

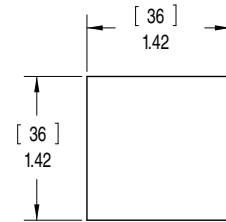

Panel cutout dimension

### Barb Dimensions

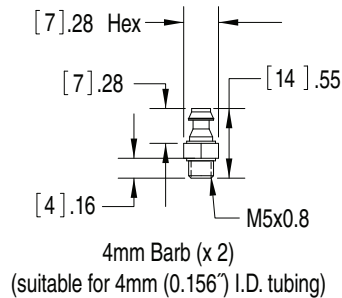

### Notes:

1. Unit to be shipped with panel mount adaptor in box
2. Unit to be supplied with 4mm fittings in box

### How to order

<b>G C 3 0</b>	<b>9</b>	<b>M 5 B</b>		<b>F 4</b>		<b>X</b>
<b>Type</b> (GC30)	<b>Accuracy</b> (9) ±1.5%	<b>Connection</b> (M5B) 4mm ID Barb	<b>Output Signal</b> (1N) 1-5Vdc: Analog w/2X NPN Type switches (1P) 1-5Vdc: Analog w/2X PNP Type switches	<b>Electrical Connection</b> (F4) 6' (2m) cable	<b>Pressure Range</b> Diff. or Gauge: (P25IW) 0.25" W.C. (P5IW) 0.50" W.C. (1IW) 1.0" W.C. (2P5IW) 2.5" W.C. (5IW) 5.0" W.C. (10IW) 10" W.C. (25IW) 25" W.C. Compound: (P25IWL) ±0.25" W.C. (P5IWL) ±0.50" W.C. (1IWL) ±1.0" W.C. (2IWL) ±2.5" W.C. (5IWL) ±5.0" W.C. (10IWL) ±10" W.C. (25IWL) ±25" W.C.	<b>Options</b> <b>XRH</b> Traceable 9 Point Calibration Report

### Contact:

Industrial Process Measurement, Inc.  
3910 Park Avenue, Unit 7  
Edison, NJ 08820  
732-632-6400  
support@instrumentation2000.com  
http://www.instrumentation2000.com